

6158 SILVERSTONE DRIVE TROY, MI 48085

This solid colonial has so much to offer beginning with a great lot located inside the sub with meticulous landscape and a private backyard.

Would you like a private tour? Call us at 833-333-GWEN!

FEATURES WE ❤️ :

1 GREAT LOCATION

This colonial has a great location in the Square Lake Place sub and filters to the Troy school district: troy Union Elementary, Larson Middle, and Troy Athens High!



2 CUSTOM LAYOUT

This home has been custom designed by the seller so that each bedroom has private access to a bath! The layout is not found anywhere else!

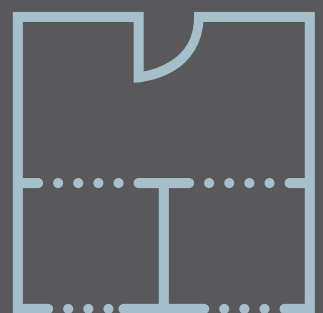

3 SKY-HIGH GREAT ROOM

The fantastic great room offers soaring 17ft ceilings, a large brick fireplace, and two doorwalls to the expansive deck!



4 FIRST FLOOR MASTER SUITE

The generous master suite offers two large his & hers closets and private access to the spacious master bath. Complete living on the first level!

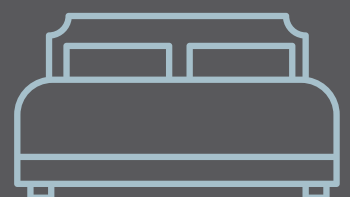

5 FINISHED BASEMENT

The finished basement features a large recreational space that can be used a lower-level family room and also offers great storage and a potential workshop!



6 PRIVATE BACKYARD

Sheiled by large trees and shrubs, this backyard is spacious with lots of room to run around, great deck space, and features meticulously maintained landscaping.

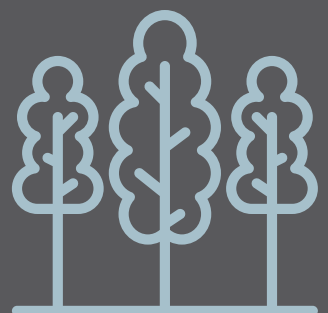

7 FUN THINGS TO DO

Major recreational/entertainment things to note: Emerald Lake, Donald J. Flynn Park, Hampton Village Center, Jaycee Park, and Downtown Troy is a short drive away!

