

29627 BOEWE DRIVE WARREN, MI 48092

This solid 4-bed colonial lies nestled on a Culdesac tree-lined street with a large private backyard in Warren's Cumberland community.

Would you like a private tour? Call us at 248-850-1521!

FEATURES WE ❤️ :

1 GREAT LOCATION

This colonial is nestled in Warren's Cumberland community. It belongs to Warren Con Schools and filters to Green Acres Elementary, Agnes E. Beer Middle & Warren Mott High!



2 TRADITIONAL LAYOUT

This solid colonial features a traditional layout that allows for a seamless ebb and flow between gathering spaces.

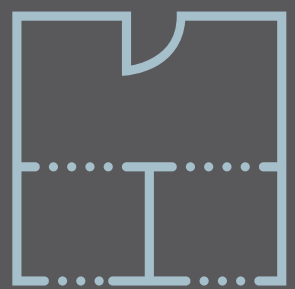

3 UPDATED FAMILY ROOM

The family room is generous with updated decor, a beautiful fireplace & mantle, and offers a doorwall to the large backyard!



4 PRACTICAL EATING AREA

The kitchen and dining room connects in a seamless flow that creates a practical eating area that you will use every day no matter the occasion.

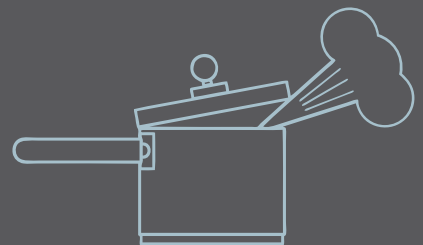

5 GENEROUS BEDROOMS

All the bedrooms are spacious with plenty of natural light, good closet space, and original hardwood flooring.



6 PRIVATE BACKYARD

The backyard is tree-lined with plenty of space to run and features a large patio connected off of the doorwall. Get ready to host some barbecues!



7 FUN THINGS TO DO

Major recreational/entertainment things to note: Red Oaks Nature Center, Downtown Warren, Halmich Park, Butcher Park, and Royal Oak is a short drive away!

